



Features of M680 Rock Drill

- Highly efficient drill for soft to hard rock
- Short stroke and fast blow rate makes it perfect for soft rock
- Ratchet wheel rotation mechanism
- Diameter of piston is large to make this drill highly efficient even at low air pressure
- Control of pusher leg is given to pusher leg

| | Metric | Imperial |
|------------------|-------------|--------------|
| Weight | 28 Kg | 62 lb |
| Length | 670 mm | 26 3/8" |
| Air consumption | 97 l/s | 206 cfm |
| Piston Diameter | 90 mm | 3 17/32" |
| Stroke Length | 45 mm | 1 3/4" |
| Shank Size | 22 x 108 mm | 7/8 x 4 1/4" |
| Working Pressure | 6 Bar | 87 psi |
| Blows Per Minute | 3300 | |



M680

MLF72D Pusher Leg

| Model | Weight | | Length Retracted | | Length Extended | | Piston Bore | | Feeding Length | | Suitable for Rock Drill |
|--------|--------|----|------------------|-------|-----------------|------|-------------|--------|----------------|------|-------------------------|
| | Kg | lb | mm | inch | mm | inch | mm | inch | mm | inch | Model |
| MLF72D | 19 | 42 | 1970 | 77.5" | 3270 | 129" | 70 | 2 3/4" | 1300 | 51" | MH 94W |

Mindrill Systems & Solutions Pvt. Ltd.

Sadananda Industrial Estate | Howrah Amta Road
P.O. Baltikuri | Howrah - 711 113

Phone: +91-33-26537610, 26538638
Sales: +91-33-65366838, +91-9830300946
Fax: +91-33-2653 4214
Email: marketing@mindrill.com
Website: www.mindrill.com

Distributed By:

©2023 © copyright 2013.XX.XX: Mindrill Systems & Solutions Pvt.Ltd. This catalogue is the exclusive property of MINDRILL and cannot be copied or reproduced without written permission.

MINDRILL
M680 Rock Drill

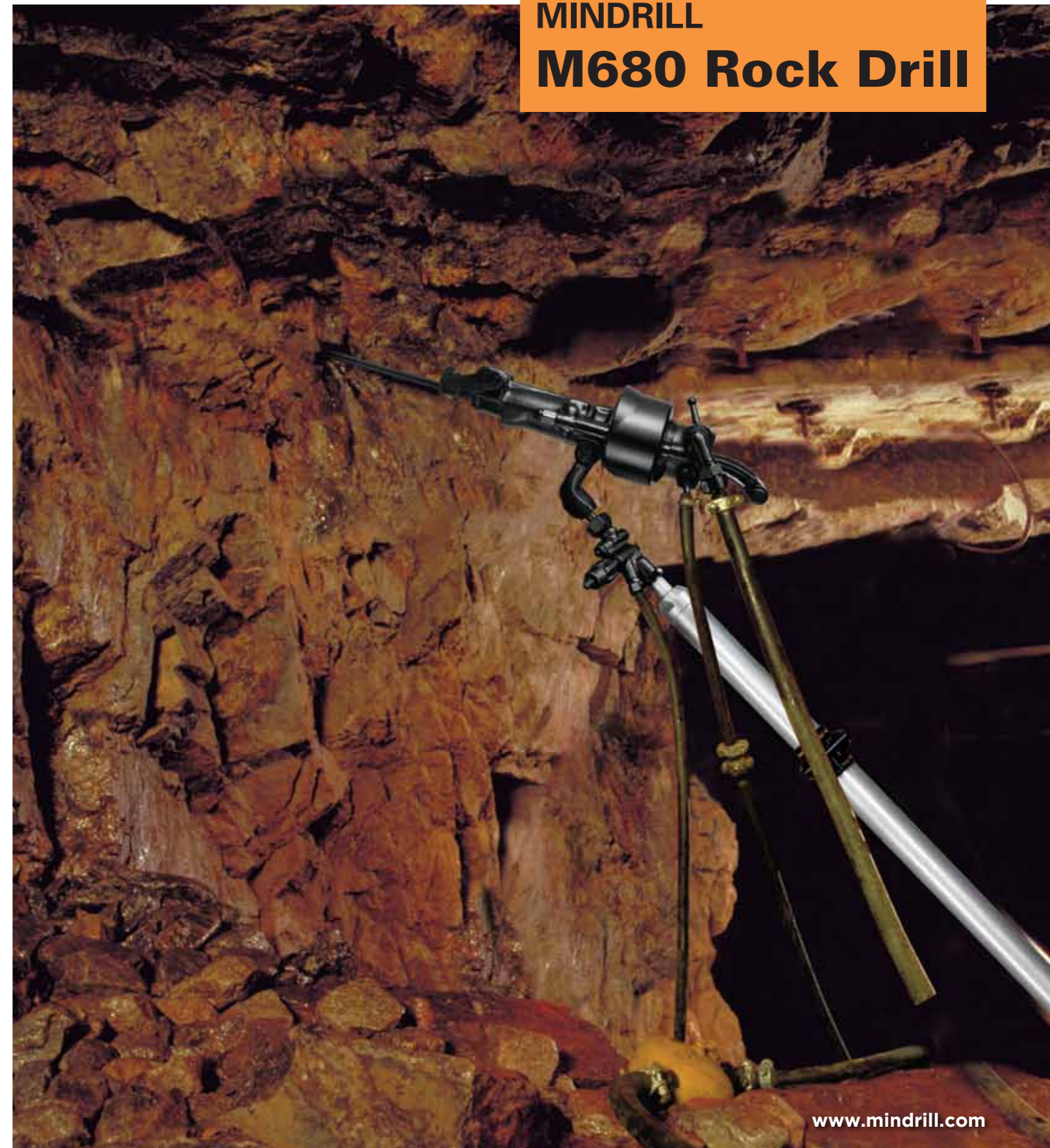

www.mindrill.com

MINDRILL M680 Rock Drill

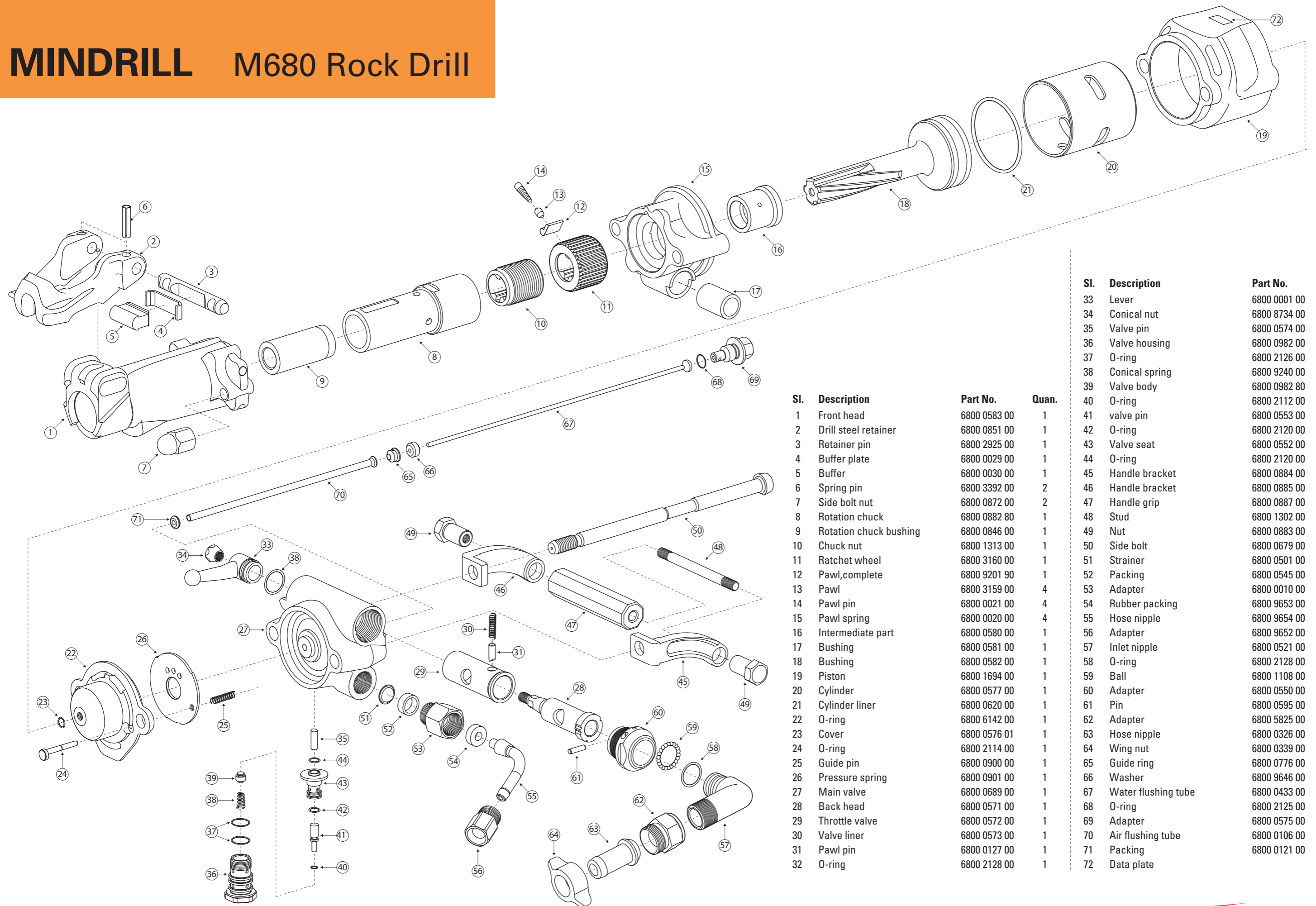

| Sl. | Description | Part No. | Quan. |
|-----|------------------------|--------------|-------|
| 1 | Front head | 6800 0583 00 | 1 |
| 2 | Drill steel retainer | 6800 0851 00 | 1 |
| 3 | Retainer pin | 6800 2925 00 | 1 |
| 4 | Buffer plate | 6800 0029 00 | 1 |
| 5 | Buffer | 6800 0030 00 | 1 |
| 6 | Spring pin | 6800 3392 00 | 2 |
| 7 | Side bolt nut | 6800 0872 00 | 2 |
| 8 | Rotation chuck | 6800 0882 80 | 1 |
| 9 | Rotation chuck bushing | 6800 0846 00 | 1 |
| 10 | Chuck nut | 6800 1313 00 | 1 |
| 11 | Ratchet wheel | 6800 3160 00 | 1 |
| 12 | Pawl,complete | 6800 9201 90 | 1 |
| 13 | Pawl | 6800 3159 00 | 4 |
| 14 | Pawl pin | 6800 0021 00 | 4 |
| 15 | Pawl spring | 6800 0020 00 | 4 |
| 16 | Intermediate part | 6800 0580 00 | 1 |
| 17 | Bushing | 6800 0581 00 | 1 |
| 18 | Bushing | 6800 0582 00 | 1 |
| 19 | Piston | 6800 1694 00 | 1 |
| 20 | Cylinder | 6800 0577 00 | 1 |
| 21 | Cylinder liner | 6800 0620 00 | 1 |
| 22 | O-ring | 6800 6142 00 | 1 |
| 23 | Cover | 6800 0576 01 | 1 |
| 24 | O-ring | 6800 2114 00 | 1 |
| 25 | Guide pin | 6800 0900 00 | 1 |
| 26 | Pressure spring | 6800 0901 00 | 1 |
| 27 | Main valve | 6800 0689 00 | 1 |
| 28 | Back head | 6800 0571 00 | 1 |
| 29 | Throttle valve | 6800 0572 00 | 1 |
| 30 | Valve liner | 6800 0573 00 | 1 |
| 31 | Pawl pin | 6800 0127 00 | 1 |
| 32 | O-ring | 6800 2128 00 | 1 |

| Sl. | Description | Part No. | Quan. |
|-----|---------------------|--------------|-------|
| 33 | Lever | 6800 0001 00 | 1 |
| 34 | Conical nut | 6800 8734 00 | 1 |
| 35 | Valve pin | 6800 0574 00 | 1 |
| 36 | Valve housing | 6800 0982 00 | 1 |
| 37 | O-ring | 6800 2126 00 | 2 |
| 38 | Conical spring | 6800 9240 00 | 1 |
| 39 | Valve body | 6800 0982 80 | 1 |
| 40 | O-ring | 6800 2112 00 | 1 |
| 41 | valve pin | 6800 0553 00 | 1 |
| 42 | O-ring | 6800 2120 00 | 1 |
| 43 | Valve seat | 6800 0552 00 | 1 |
| 44 | O-ring | 6800 2120 00 | 1 |
| 45 | Handle bracket | 6800 0884 00 | 1 |
| 46 | Handle bracket | 6800 0885 00 | 1 |
| 47 | Handle grip | 6800 0887 00 | 1 |
| 48 | Stud | 6800 1302 00 | 1 |
| 49 | Nut | 6800 0883 00 | 2 |
| 50 | Side bolt | 6800 0679 00 | 2 |
| 51 | Strainer | 6800 0501 00 | 1 |
| 52 | Packing | 6800 0545 00 | 1 |
| 53 | Adapter | 6800 0010 00 | 1 |
| 54 | Rubber packing | 6800 9653 00 | 1 |
| 55 | Hose nipple | 6800 9654 00 | 1 |
| 56 | Adapter | 6800 9652 00 | 1 |
| 57 | Inlet nipple | 6800 0521 00 | 1 |
| 58 | O-ring | 6800 2128 00 | 1 |
| 59 | Ball | 6800 1108 00 | 20 |
| 60 | Adapter | 6800 0550 00 | 1 |
| 61 | Pin | 6800 0595 00 | 1 |
| 62 | Adapter | 6800 5825 00 | 1 |
| 63 | Hose nipple | 6800 0326 00 | 1 |
| 64 | Wing nut | 6800 0339 00 | 1 |
| 65 | Guide ring | 6800 0776 00 | 1 |
| 66 | Washer | 6800 9646 00 | 1 |
| 67 | Water flushing tube | 6800 0433 00 | 1 |
| 68 | O-ring | 6800 2125 00 | 1 |
| 69 | Adapter | 6800 0575 00 | 1 |
| 70 | Air flushing tube | 6800 0106 00 | 1 |
| 71 | Packing | 6800 0121 00 | 1 |
| 72 | Data plate | | 1 |

RELIABILITY UNPARALLELED POWER UNMATCHED

